

RESEARCH ENTRANCE TEST (RET 2020) FOR PhD at NIFTEM

INSTRUCTIONS FOR ONLINE EXAM

MOCK EXAM : 17th SEPTEMBER (Thursday)
Exam Time : 11.00 am -12.00 noon

FINAL EXAM : 18th SEPTEMBER (Friday)
Exam Time : 11:00 am – 12:30 noon
Exam Duration : 1 hours 30 min
No. of Questions : 70
Questions Type : MCQ

**The exam server will be made accessible from 8:00 AM on both exam days.
Your login & password SHALL NOT work when the exam server is OFF.**

LOGIN ID : as mentioned in your email
PASSWORD : as mentioned in your email
COURSE/PAPER : as mentioned in your email

Same login credentials shall work on 17th & 18th September for all the candidates.

Candidates must ensure they are attempting the same paper which they have opted in the application form. In case of any concern, please get this corrected/clarified till the end of day 17th Sep. No such requests shall be addressed on the day of final exam (18th Sep) & attempting any other paper will lead to disqualification.

Exam can **either** be taken on Android Mobile Phone by downloading a mobile app from the URL mentioned below (see instructions for mobile app) **or** directly from the Chrome Browser on your Windows Laptop/Desktop. **No app is required for exam to be taken from the Chrome Browser.**

INSTRUCTIONS FOR BROWSER ACCESS

Type the URL <https://niftem.icalibrator.com> in your chrome browser. The Chrome is the preferred browser. In the login page which is displayed enter your **LOGIN ID & PASSWORD**. Click on the Login button. It will ask you permission for taking video and audio, please give these permissions; **otherwise you will not be able to continue with the exam.**

Ensure Google Chrome on your Laptop/Desktop has been pre-configured to allow Camera & Microphone permissions. If not done already, pls follow as below

Open Chrome.

At the top right, click more. Settings.

Under "Privacy and security," click Site settings.

Click Camera or Microphone. Turn on or Ask before accessing. Review your blocked and allowed sites.

https://niftem.icalibrator.com should be your allowed site.

Ensure your Laptop/Desktop Date is correct & Time is set at (UTC+05:30) Chennai, Kolkata, Mumbai, New Delhi

Ensure your Browser Cache is cleaned. If not done already, pls follow as below

Open Chrome.

At the top right, click more. Click More Tools, Clear Browsing Data

Select all time, Next to "Cookies & other site data" and "Cached images & files"" check the boxes.

Click Clear Data.

After successful login, you will be shown the exam info (Course/Paper) that you have to take. If you login early, it will show when it is expected to start. The start Button will show up when stipulated time arrives. Click on the Start Button. It will show you the following instructions. Continue and take the test.

INSTRUCTIONS ABOUT QUESTIONS

- The questions will be displayed one question at a time.
- Next and Previous buttons will take you to the next or previous question.
- The time remaining will be shown at the top of the page and will be updated every second.
- Clicking the Submit button shall submit all your answers and end the session. Once submitted, you will not be able to re-attempt the exercise.
- Each multiple-choice question has only one correct answer which should be selected for full marks.
- There may be some text questions where you are required to fill in answers using your keypad/keyboard.
- In match-the-following questions, you need to use the Up button to move the choices on the right up to rearrange them and place the right choices in front of the ones given on the left.

PLEASE NOTE

- The Submit button will be enabled after suitable time has elapsed
- It is compulsory to click the Submit button after completing the exam.
- If you exceed the time limit, the system will prompt you and forcefully submit your answers.

IMPORTANT

- Make sure your microphone is working and on all the time during exam.
- Please do not close the browser without submitting the exercise properly.
- **Please do not use the browser's back and forward buttons for navigating through the questions. Use the Next and Previous buttons on the page.**
- Please do not navigate out of the browser, or open a new tab. All these actions are recorded in the server and it will lead to disqualification.
- Please make sure that you have good bandwidth uninterrupted internet connection. (At least 2Mbps upload & download speed).
- Let there be distance of at least 1-1.5 ft in between camera/webcam of your laptop/monitor and make sure your face to upper chest portion is visible in the camera. Otherwise, you may be disqualified.
- **Use of unfair means shall disqualify your candidature. Unfair means like wearing headphones, talking to someone on phone or in the same room, getting prompt from someone in your room, allowing someone else to look at your exam screen, switching app/device, having your face not properly seen in the camera, going out of camera range, use of additional devices to access internet search & not following proctor's advice/warning communicated to you through a pop-up message on your screen.**
- All your movements & exam screen activities are getting proctored by human invigilators & AI technology on real time basis.
- Reject incoming web calls during examination. While taking exams on browser, any incoming web calls acceptance shall be treated as application switcher & doing so would submit your examination.
- If any connectivity issue is observed, the application might prompt you. You can try with another network if you have one available. If connectivity is very poor, you may get logged out with a message. You can continue the exam after logging in again. The server will be notified of all re-login attempts. It is advisable to check your internet bandwidth before sitting for the examination as multiple instances of logging in/out because of internet connection may

disqualify your candidature. The decision of respective authorities at NIFTEM shall be final in this regard.

The Exam is conducted in proctored mode. Your photo and video will be taken continuously and sent to the server. The photo may also be sampled and displayed in a small window on the screen. Please ensure that your face is fully visible in the photo, and the lighting conditions are favourable. Ensure that you are facing the light and there is no light at your back (like an open window). In case of any unfair means activity/instance detected, you shall be given THREE warnings by Proctor as seen on your screen in a popped up message, the 4th instance, if it gets detected, would disqualify you automatically.

OR

INSTRUCTIONS FOR ANDROID APP ON YOUR MOBILE

Install the App iCalibrator's PAAS™ from the below URL after 9AM on 16th September 2020

<https://www.icalibrator.com/apks/icalibrator.apk>

ENSURE android mobile app version should be displayed as ver 3.29 (at the log-in screen)

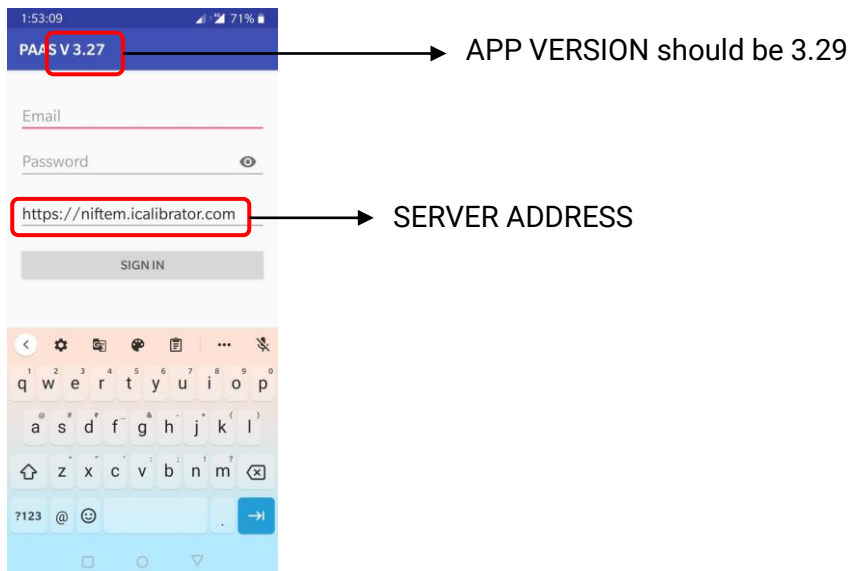

When you start the application for the first time it will ask you to allow **display over other apps**, please **enable** this option. It will also ask you permission for taking video and audio, please give these permissions. **Otherwise you will not be able to continue with the exam.**

Enter your (as mentioned above)

LOGIN ID :
PASSWORD :
SERVER ADDRESS : <https://niftem.icalibrator.com>

Click on the SIGN IN button. It will show you the following instructions. You may continue and take the test

GENERAL

- Once you continue from this page you will be shown the next exam that you have to take.
- The exam will start at the stipulated time. If you login early, it will show a countdown message.

- The question paper would be displayed automatically when the exam starts. When the stipulated exam time is over, the application would automatically submit your test.

INSTRUCTIONS ABOUT QUESTIONS

- The questions will be displayed one question at a time.
- Right to Left OR Left to Right swipes on screen will take you to the next or previous question.
- The time remaining will be shown at the top of the page and will be updated every second.
- Clicking the Submit button in the Question Navigator submits all your answers and ends the session. Once submitted, you will not be able to re-attempt the exercise.
- Each multiple-choice question has only one correct answer which should be selected for full marks.
- There may be some text questions where you are required to fill in answers using your keypad.
- There may be match-the-following questions, where you need to use the Up button to move the choices on the right up to rearrange them and place the right choices in front of the ones given on the left.

PLEASE NOTE

- It is compulsory to click the Submit button after completing the exam.
- If you exceed the time limit, the system will prompt you and forcefully submit your answers.

IMPORTANT

- Make sure your microphone is working and on all the time during exam.
- Please do not close the app without submitting the exercise properly.
- Please do not use the back, home, and application switcher buttons of your device during the exam. Doing so would submit your examination.
- Please make sure that you have good bandwidth uninterrupted internet connection. (At least 2Mbps upload & download speed).
- Let there be distance of at least 1-1.5 ft in between camera of your mobile and make sure your face to upper chest portion is visible in the camera. Otherwise, you may be disqualified.
- Use of unfair means shall disqualify your candidature. Unfair means like wearing headphones, talking to someone on phone or in the same room, getting prompt from someone in your room, allowing someone else to look at your exam screen, switching app/device, having your face not properly seen in the camera, going out of camera range, use of additional devices to access internet search & not following proctor's advice/warning communicated to you through a pop-up message on your screen.
- All your movements & exam screen activities are getting proctored by human invigilators & AI technology on real time basis.
- Reject incoming calls during examination. While taking exams on mobile, any incoming calls acceptance shall be treated as application switcher & doing so would submit your exam.
- If any connectivity issue is observed, the application might prompt you. You can try with another network if you have one available. If connectivity is very poor, you may get logged out with a message. You can continue the exam after logging in again. The server will be notified of all re-login attempts. It is advisable to check your internet bandwidth before sitting for the examination as multiple instances of logging in/out because of internet connection may disqualify your candidature. The decision of respective authorities at NIFTEM shall be final in this regard.

The Exam is conducted in proctored mode. Your photo and video will be taken continuously and sent to the server. The photo may also be sampled and displayed in a small window on the screen. Please ensure that your face is fully visible in the photo, and the lighting conditions are favourable. Ensure that you are facing the light and there is no light at your back (like an open window). In case of any unfair means activity/instance detected, you shall be given THREE warnings by Proctor as seen on your screen in a popped up message, the 4th instance, if gets detected, would disqualify you automatically.

FAQ

- Exam Server shall be ON at 8 AM on both the exam days. The login & password shall not work when exam server is OFF.
- Final Exams shall start at 11:00 am sharp. If you login early, a timer shall start.
- MOCK exam, having dummy questions, shall not get evaluated. This is to help you understand the platform & the process so that you shouldn't face any issue on the day of final exam.
- Each question shall be of 1 mark each. No negative marking.
- For Candidates attempting exam from outside INDIA, they can take it from Chrome Browser on laptop/Desktop. App will not be available outside India
- Exam Syllabus has already been uploaded on NIFTEM website, department wise. RET syllabus and interview scheme of exam has already been mentioned in the admission brochure 2020-21 (page 38).
- Once logged in, logging out or switching to another application or browser tab or accepting incoming calls or moving out of the exam screen for any reason shall submit your exam
- Once an exam is submitted by clicking on submit button, you will not be allowed to login again. So press SUBMIT once you are through & sure to submit your exam.
- You can come back to previous questions & change your response multiple times during the exam time.
- You can use the question navigator to go to any question out of sequence. In the App, you can click on the question navigator button and choose the question, in the browser it is always visible on the right most panel.
- The QUESTION NAVIGATOR dashboard colors, GREEN - Question attempted; YELLOW: SEEN not attempted; ORANGE: attempted but you wish to review it later. If you have submitted your answers with ORANGE options (means you wished to change/review your answer option (already attempted) if time would have permitted but didn't get time to change the earlier marked option), it shall be treated as GREEN marked & attempted.

For any technical issues, you may contact (Call / WhatsApp) Mr. Anil Arora @ 9811812307 on 16th& 17th September (9am – 9pm) & before the start of the exam on 18th Sep (WhatsApp ONLY). No calls or messages shall be answered during exam time.

Pls share your LOGIN ID, PASSWORD & ISSUE with SCREEN SHOT of the exam application screen (Browser/Mobile App).

.....X.....X.....